

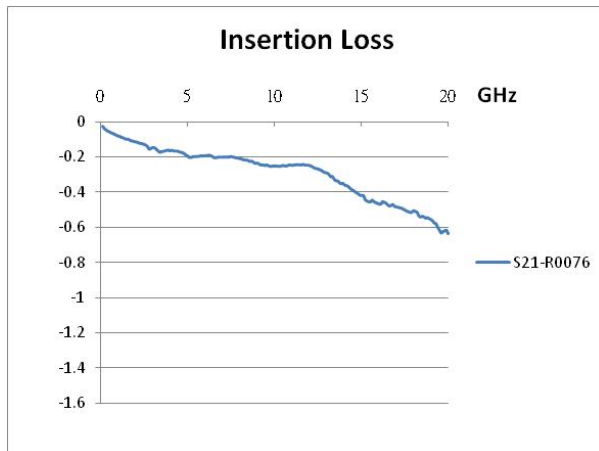

ALLSTRON RF Probe 26GHz

Model: ASP-GS-150-26-P

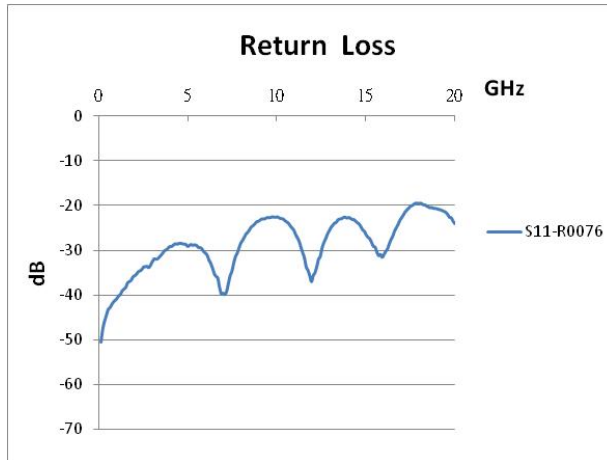

- **26GHz Electric Performance**
- Characteristic impedance: 50Ω
- Frequency range: DC ~ 26GHz
- DC voltage: max.100V
- DC current: max 1A
- RF Power @ 10GHz max: 5W
- Contact resistance on Au: 0.05Ω
- Return loss to 20GHz: max. -18dB
- Insertion loss to 20GHz: - 0.6dB

- **26GHz Mechanic Performance**
- Cantilever needle material: Nickel alloy
- Body: Aluminum alloy
- Contact pressure at 2mils over travel: ~ 20g
- Contact cycles: min. 1 Million touch downs
- Ground and Signal alignment error: max.15um
- Planarity: max. 15um
- Scribing mark width: 30um
- Connector: SMA connector
- Available pitch: 50um to 1250um in 50um steps
- Available configuration: SG and GS
- Available connector angle: 45 or 90 degree

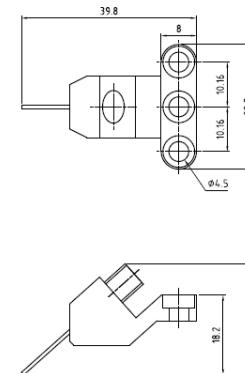
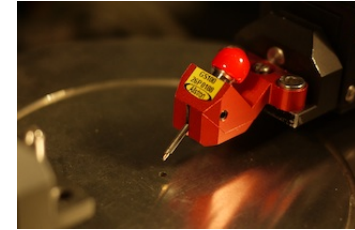

UNIT : mm

Version 2.0 Dated: SEP 6 2011

www.allstron.com